

# TL6300 SERIES TACT SWITCH

ANTI-VANDAL SWITCHES  
 DETECTOR SWITCHES  
 DIP SWITCHES  
 KEYLOCK SWITCHES  
 NAVIGATION SWITCHES  
 PUSHBUTTON SWITCHES  
 ROCKER SWITCHES  
 ROTARY SWITCHES  
 SLIDE SWITCHES  
 SNAP ACTION SWITCHES  
**TACTILE SWITCHES**  
 TOGGLE SWITCHES  
 CAP OPTIONS



## APPLICATIONS / MARKETS



Audio / Visual

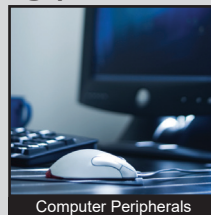

Computer Peripherals

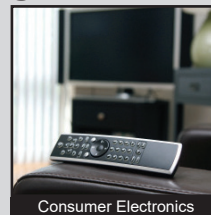

Consumer Electronics

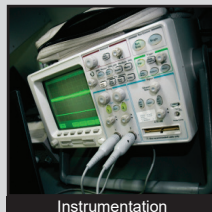

Instrumentation

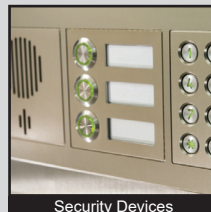

Security Devices



Medical Equipment

**RoHS**

## SPECIFICATIONS

**Contact Arrangement:** SPST  
**Contact Rating:** 50mA @ 12VDC  
**Contact Resistance:** 100mΩ Initial  
**Insulation Resistance:** 100 MΩ @ 100 VDC  
**Dielectric Strength:** 250 VAC  
**Electrical Life:** 10,000,000 cycles  
**Operating Temperature:** -40°C to 90°C  
**Storage Temperature:** -40°C to 90°C  
**Travel:** 0.3mm  
**Actuation Force:** 260 gf  
**Moisture Protection:** IP67  
**Bounce:** 10m Second Max.

## FEATURES & BENEFITS

- 10,000,000 cycle life expectancy
- IP67 ingress protection
- PCB Mount
- Sharp tactile response

## PART NUMBER CONFIGURATOR

Series	Actuator	Actuation Force	Contact Material	Terminal
<input type="text" value="TL6300"/>	<input type="text" value="A - 7.30mm Height"/>	<input type="text" value="F260 - 260 gf"/>	<input type="text" value="Q - Silver"/>	<input type="text" value="P - Thru Hole PCB"/>

*Specifications subject to change without notice 2.15.2019*



**E-SWITCH®**

www.e-switch.com

800.867.2717

1

# TL6300 SERIES TACT SWITCH

## BODY DIMENSIONS

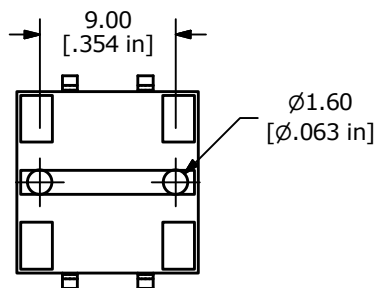
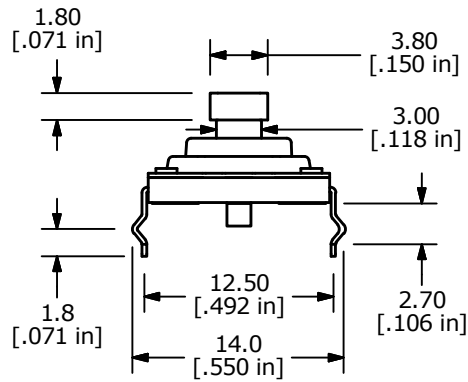
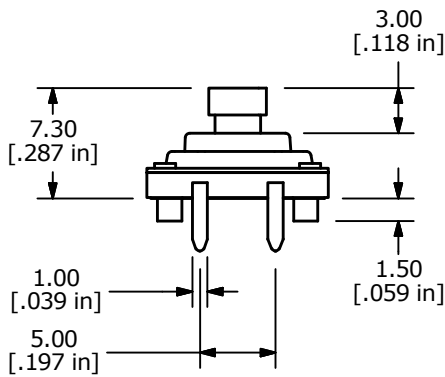
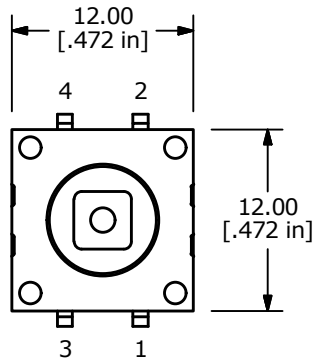
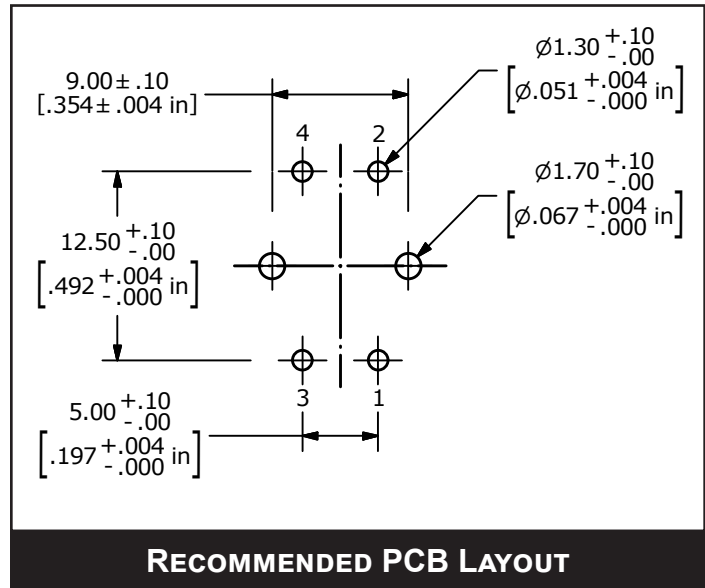
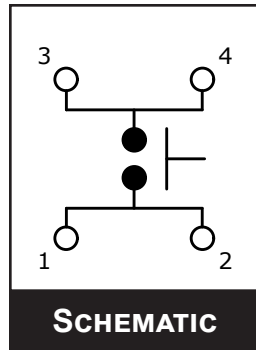

# Mouser Electronics

Authorized Distributor

Click to View Pricing, Inventory, Delivery & Lifecycle Information:

[E-Switch:](#)

[TL6300AF260QP](#)